

DRAFT PLAN OF SUBDIVISION

Micks

SP-T-1004

Part of Lot 14
Concession 6
Township of Springwater
County of Simcoe

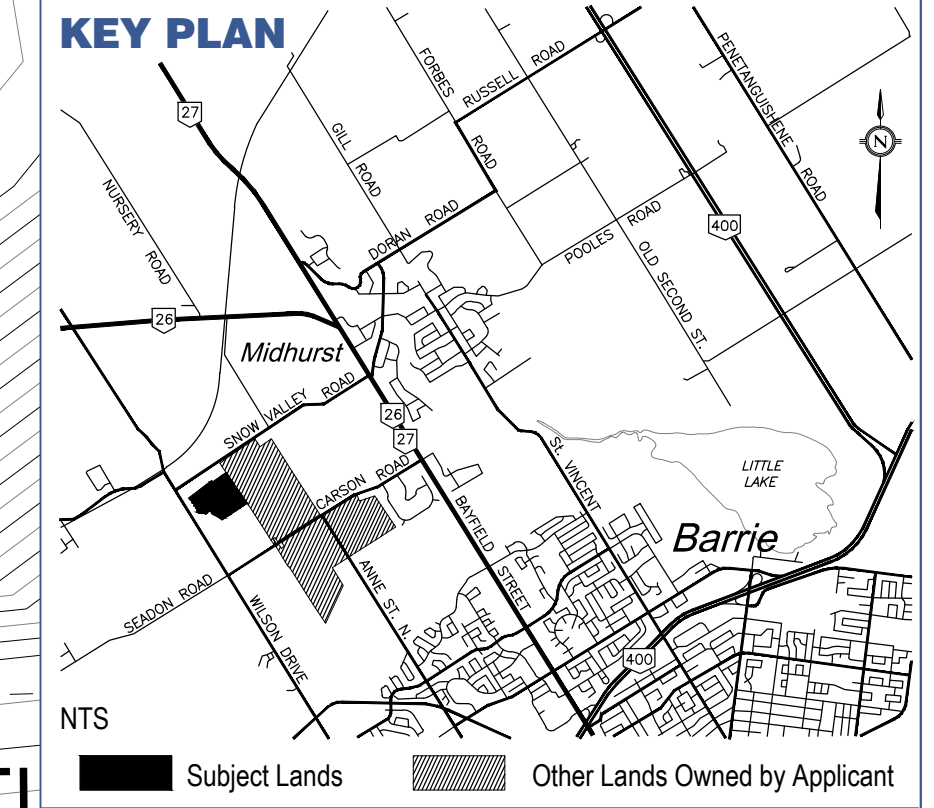

SCHEDULE OF LAND USE

LOT/BLOCK	LAND USE	LAND USE	UNITS	AREA (ha)
Lots 1-304	Low Density Residential			
	Single Detached - 12.2m (B units)		82	
	Single Detached - 9.8m (C units)		190	11.02
	Semi-Detached - 7.625m (D units)		64	
Blocks 305-315	On-Street Townhouses (OSTH)		87	1.94
Block 316	Storm Water Management		4.20	
Block 317	Pumping Station		0.05	
Block 318	Open Space		0.11	
Blocks 319-337	Residential Reserve		0.12	
Block 338	Reserve		0.15	
Roads	20.0m ROW		2.396m	6.37
TOTAL			2,396m	23.96

Net Density - 423 units / 23.96 ha = 17.65 upha

OWNER'S AUTHORIZATION

I hereby authorize Malone Given Parsons Ltd. to prepare and submit this Draft Plan of Subdivision to the County of Simcoe.

1757704 Ontario Inc. _____ Date _____

SURVEYOR'S CERTIFICATE

I hereby certify that the boundaries of the lands to be subdivided as shown on this Plan and their relationship to the adjacent lands are accurately and correctly shown.

Paul Edward
Ontario Land Surveyor
RPE Surveying Ltd. _____ Date _____

ADDITIONAL INFORMATION

AS REQUIRED UNDER SECTION 51(17) OF THE PLANNING ACT, CHAPTER P.13(R.S.O. 1990).
(a),(e),(f),(g),(j),(l) - As shown of the Draft Plan.
(b),(c) - As shown on the Draft and Key Plan.
(d) - Land to be used in accordance with the Schedule of Land Use.
(i) - Sand.
(h),(k) - Full municipal services to be provided.

Prepared by:
MALONE GIVEN PARSONS LTD.
140 Renfrew Drive, Suite 201
Markham, Ontario, L3R 6B3
Tel: (905) 513-0170
www.mgp.ca

mbtw watchorn

Scale: 1:1000 Date: October 7, 2013
Project No.: 12-1239

Date	Revision

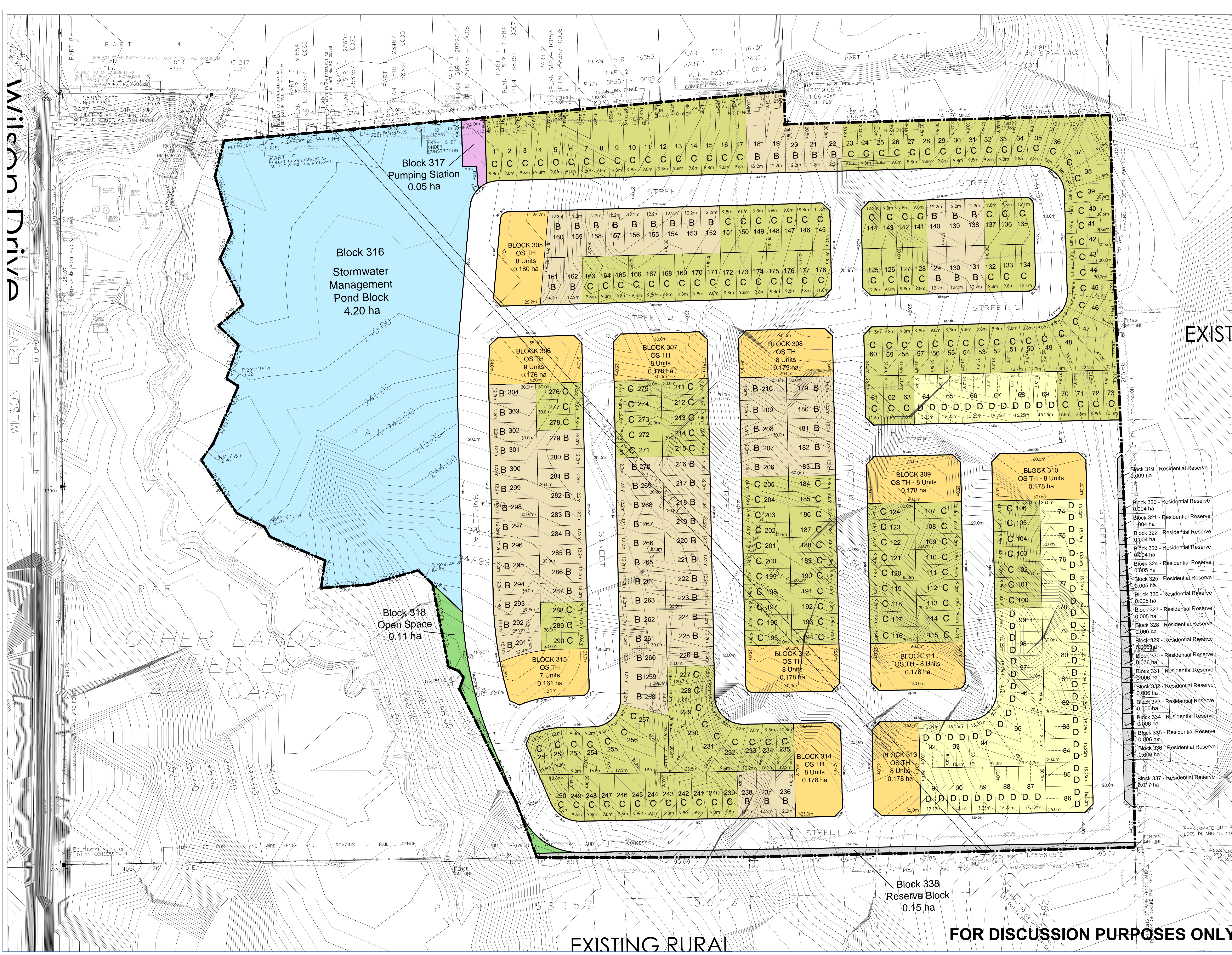

EXISTING RURAL

FOR DISCUSSION PURPOSES ONLY

Wilson Drive