

DRAFT PLAN OF SUBDIVISION

Rome
SP-T-1007

Part of Lot 16
Concession 5
Township of Springwater
County of Simcoe

KEY PLAN

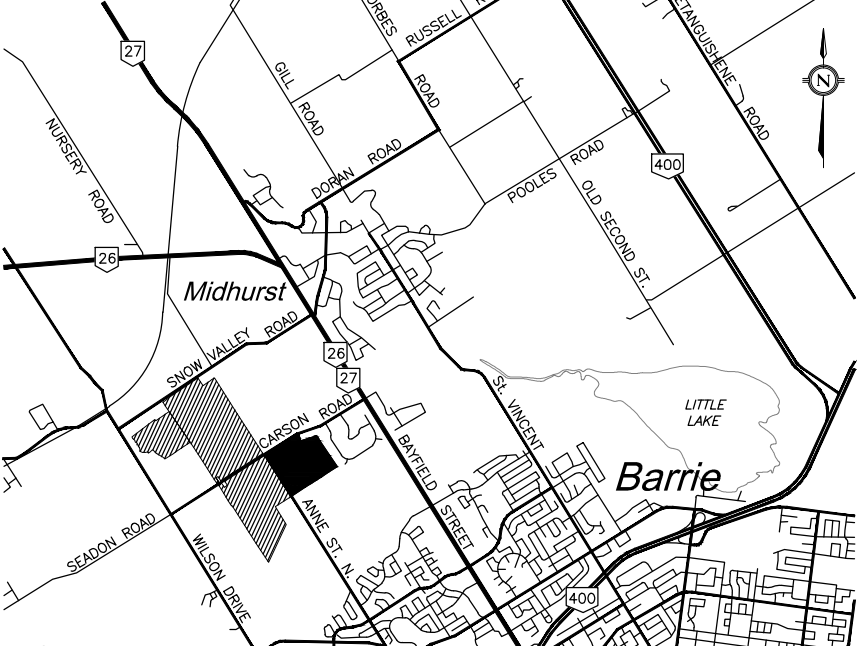

NTS
 Subject Lands
 Other Lands Owned by Applicant

SCHEDULE OF LAND USE

LOT/BLOCK	LAND USE	LAND USE	UNITS	AREA (ha)
Lots 1-281	Low Density Residential			
	Single Detached - 15.25m (A units)			
	Single Detached - 12.2m (B units)	86	12.74	
	Single Detached - 9.8m (C units)	64		
	Semi-Detached - 7.625m (D units)	90		
Blocks 282-298	Laneway Townhouse Residential LWTH		2.30	
Block 299	High Density / Mixed Use		1.18	
Blocks 300-301	Open Space		14.26	
Blocks 302-305	Parks		1.37	
Blocks 306-308	Walkways		0.13	
Blocks 309-310	Road Widening		0.60	
Roads	28.0m ROW	61m		
	23.0m ROW	1,211m		
	20.0m ROW	1,866m		
	10.0m Lane	686m		
			7.45	
TOTAL		3,824m	415	40.03

Net Density - 415 units / 25.77 ha = 16.1 upha
 (Excludes High Density / Mixed Use Block)

OWNER'S AUTHORIZATION

I hereby authorize Malone Given Parsons Ltd. to prepare and submit this Draft Plan of Subdivision to the County of Simcoe.

1757699 Ontario Inc. _____ Date _____

SURVEYOR'S CERTIFICATE

I hereby certify that the boundaries of the lands to be subdivided as shown on this Plan and their relationship to the adjacent lands are accurately and correctly shown.

Paul Edward
 Ontario Land Surveyor
 RPE Surveying Ltd. _____ Date _____

ADDITIONAL INFORMATION

AS REQUIRED UNDER SECTION 51(17) OF THE PLANNING ACT, CHAPTER P.13(R.S.O. 1990).
 (a),(e),(f),(g),(j),(l) - As shown of the Draft Plan.
 (b),(c) - As shown on the Draft and Key Plan.
 (d) - Land to be used in accordance with the Schedule of Land Use.
 (i) - Sand.
 (h),(k) - Full municipal services to be provided.

Prepared by:
MALONE GIVEN PARSONS LTD.
 140 Renfrew Drive, Suite 201
 Markham, Ontario, L3R 6B3
 Tel: (905) 513-0170
 www.mgp.ca

mbtw watchorn

Scale: 1:1250
 Date: October 7, 2013
 Project No.: 12-1239

Date	Revision

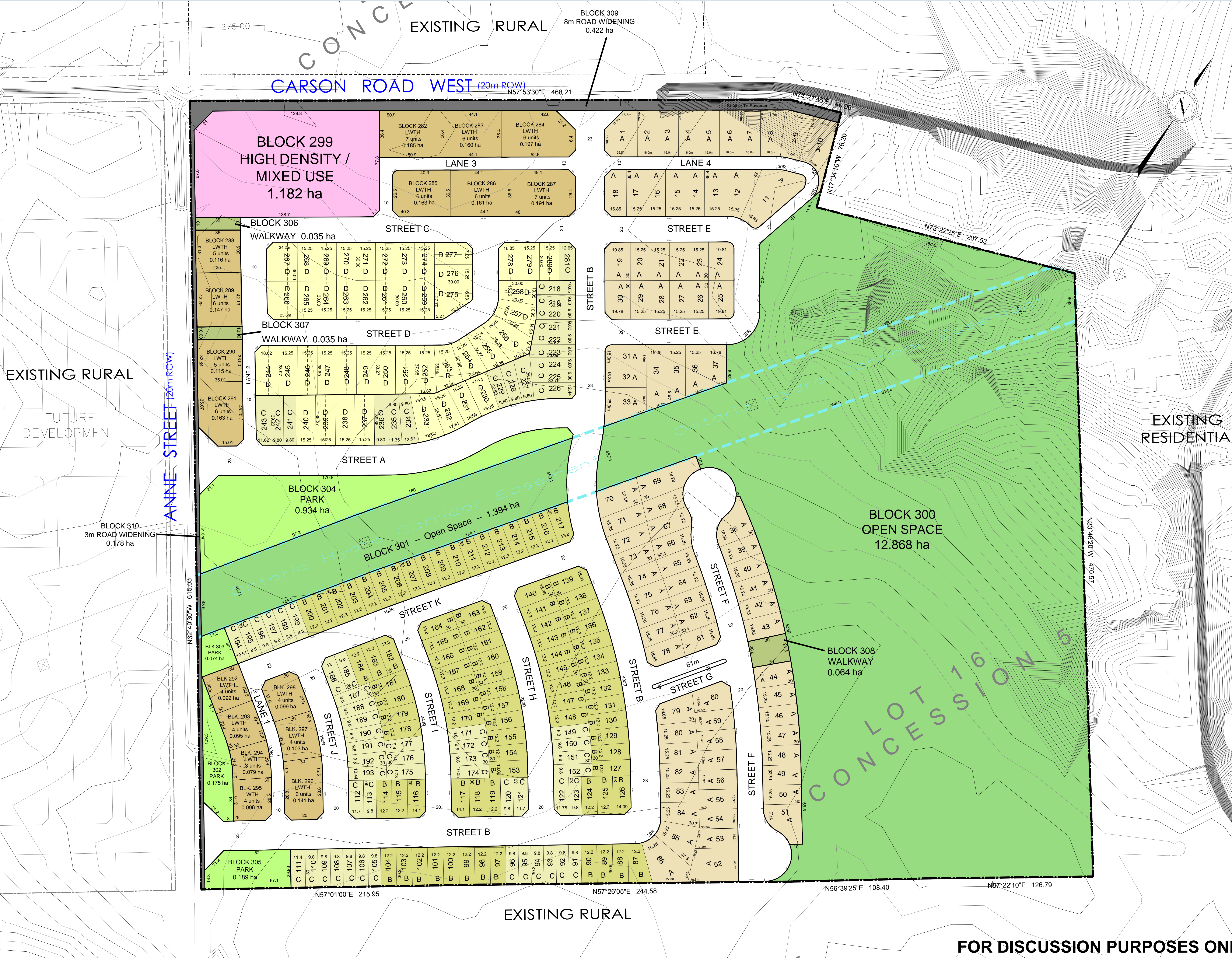

FOR DISCUSSION PURPOSES ONLY