

MICKS
 SP-T-1004/ZB-2013-010
 1757704 Ont. Ltd.
 SnowValley Road

Wilson Drive

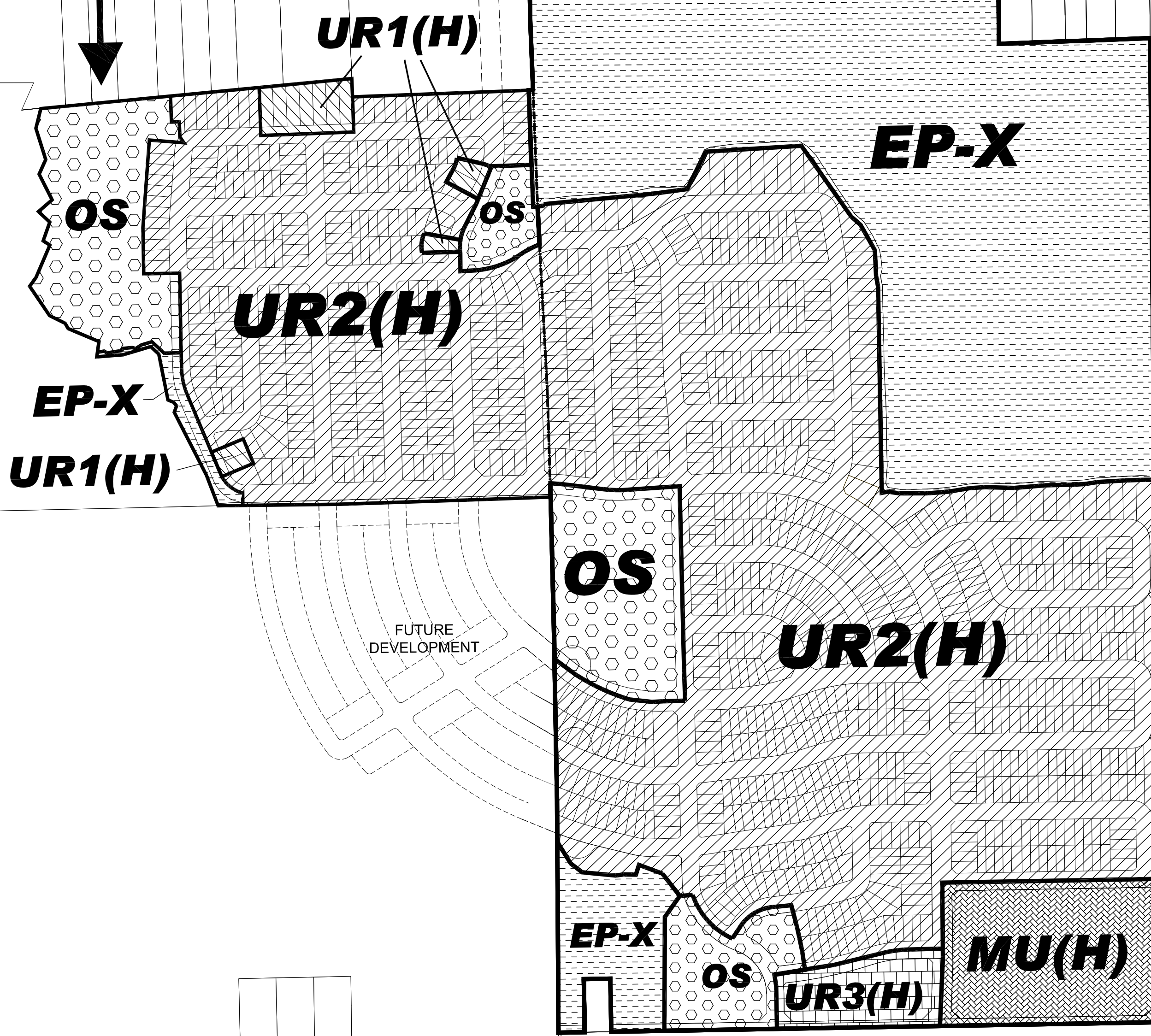

D. HICKLING
 SP-T-1005/ZB-2013-009
 1757688 Ont. Ltd.

Anne Street

FUTURE DEVELOPMENT

Carson Road West

A. & R. HICKLING
 SP-T-1006/ZB-2013-011
 1757690 Ont. Ltd. /
 1757689 Ont. Ltd.

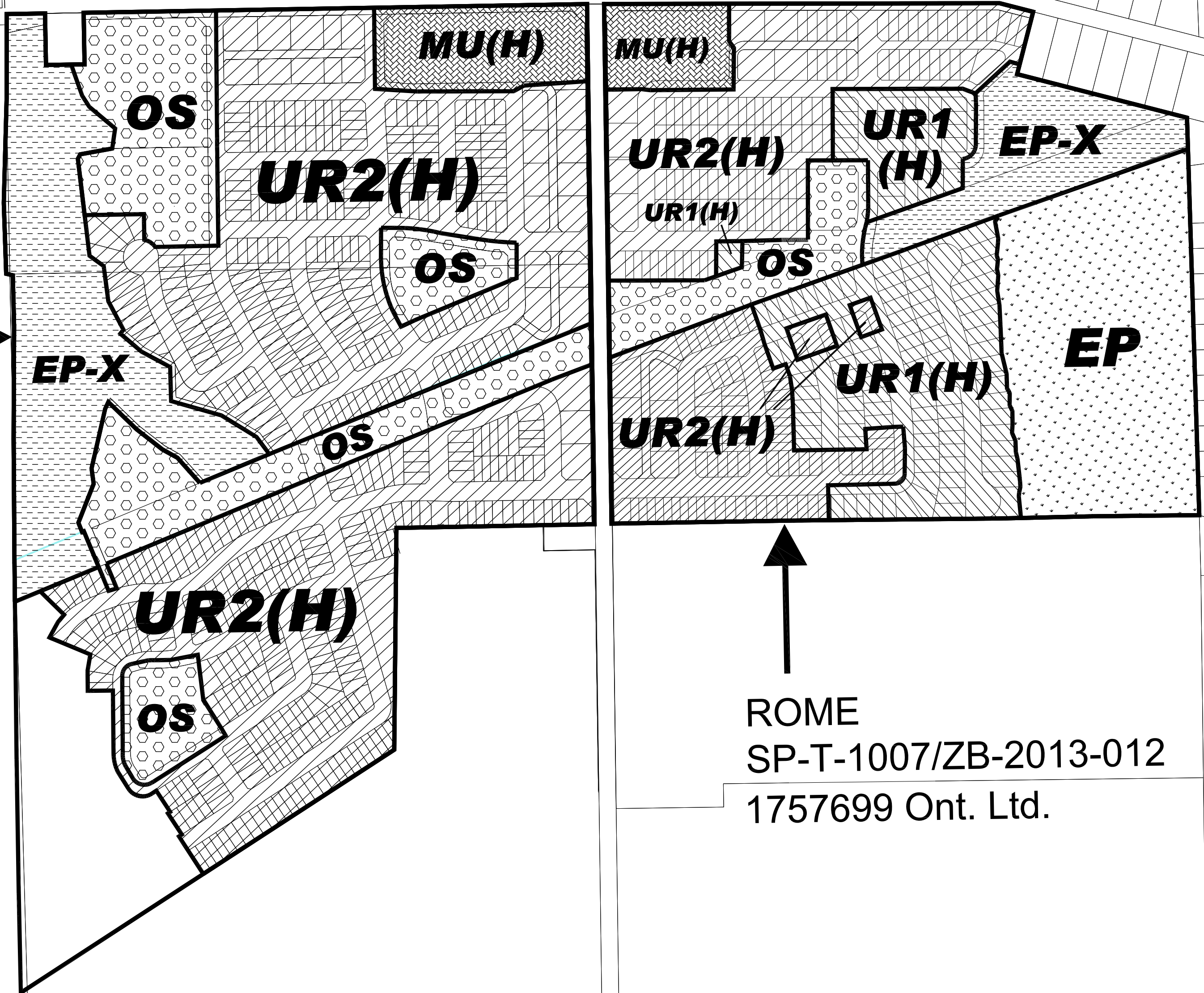

ROME
 SP-T-1007/ZB-2013-012
 1757699 Ont. Ltd.

**CARSON NEIGHBOURHOOD
 COMPOSITE ZONING SCHEDULE**

TOWNSHIP OF SPRINGWATER
 COUNTY OF SIMCOE

Prepared by:
MALONE GIVEN PARSONS LTD.
 140 Renfrew Drive, Suite 201
 Markham, Ontario, L3R 6B3
 Tel: (905) 513-0170
 www.mgp.ca

mbtw watchorn

KEY PLAN

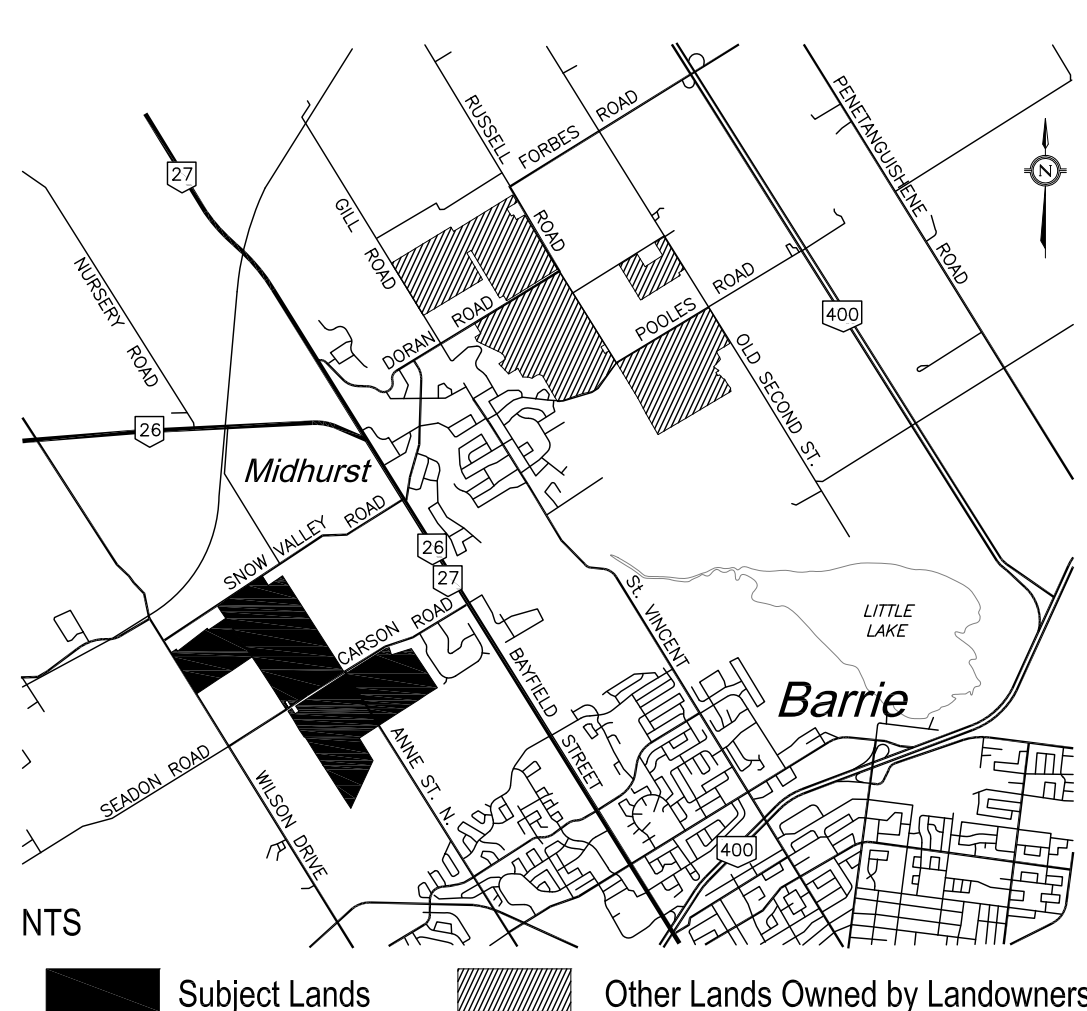

Zoning Legend

- Lands to be rezoned from Agricultural (A) Zone to Urban Residential 1 (UR1) (H) Zone
- Lands to be rezoned from Agricultural (A) Zone to Urban Residential 2 (UR2) (H) Zone
- Lands to be rezoned from Agricultural (A) Zone to Urban Residential 3 (UR3) (H) Zone
- Lands to be rezoned from Agricultural (A) Zone to Mixed Use (MU) Zone
- Lands to be rezoned from Agricultural (A) Zone to Open Space (OS) Zone
- Lands to be rezoned from Agricultural (A) Environmental Protection (EP-X) Zone
- Lands to be rezoned from Agricultural (A) Environmental Protection (EP) Zone

Scale: 1:4000

Date: June 16, 2014
 Project No.: 12-1239