

EXISTING RURAL

Doran Road

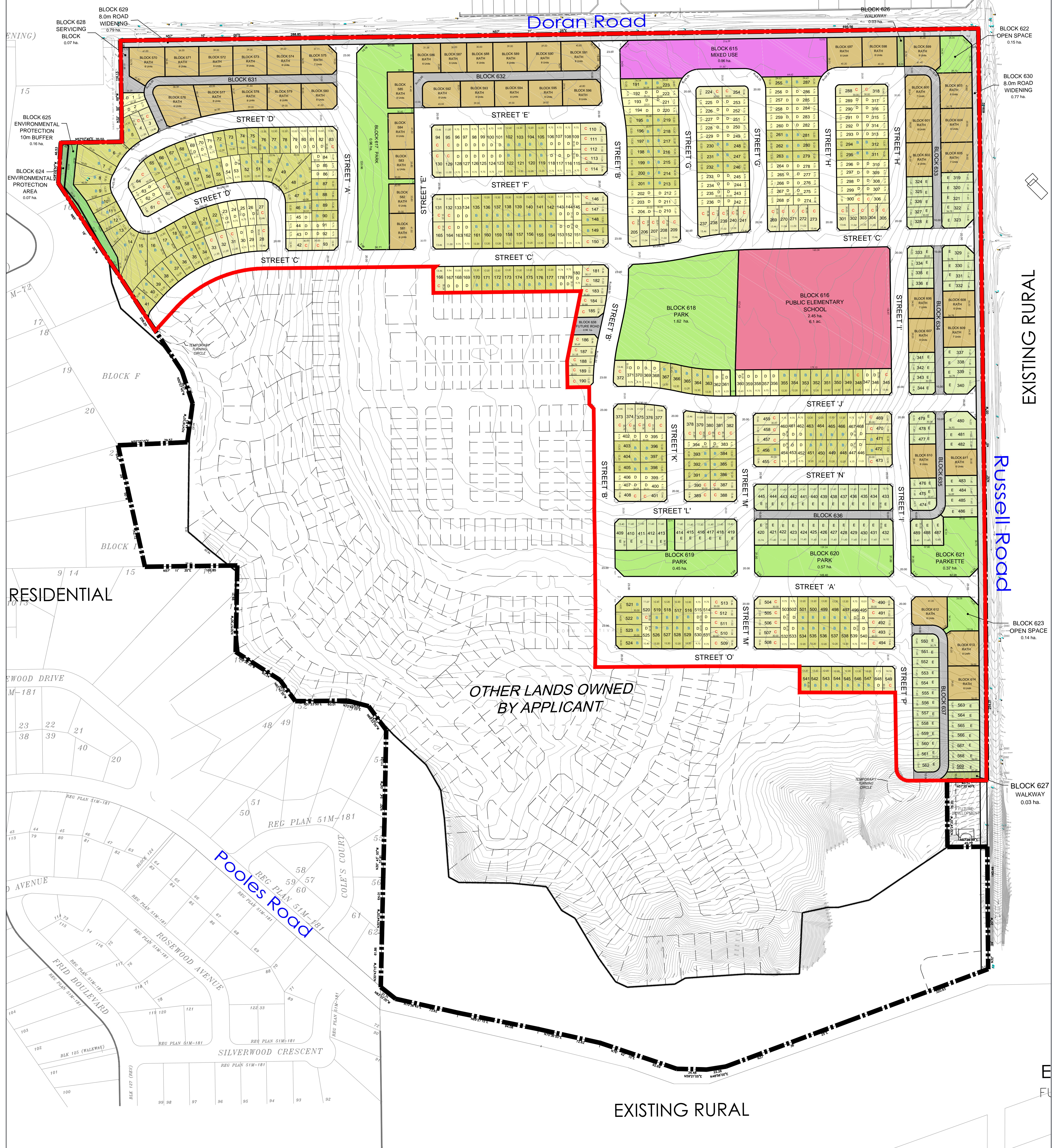

EXISTING RURAL

Russell Road

EXISTING RURAL

DRAFT PLAN OF SUBDIVISION

Bell-Coutts-Rusdor

SP-T-1001

Part of Lots 13 & 14
Concession 3
Township of Springwater
County of Simcoe

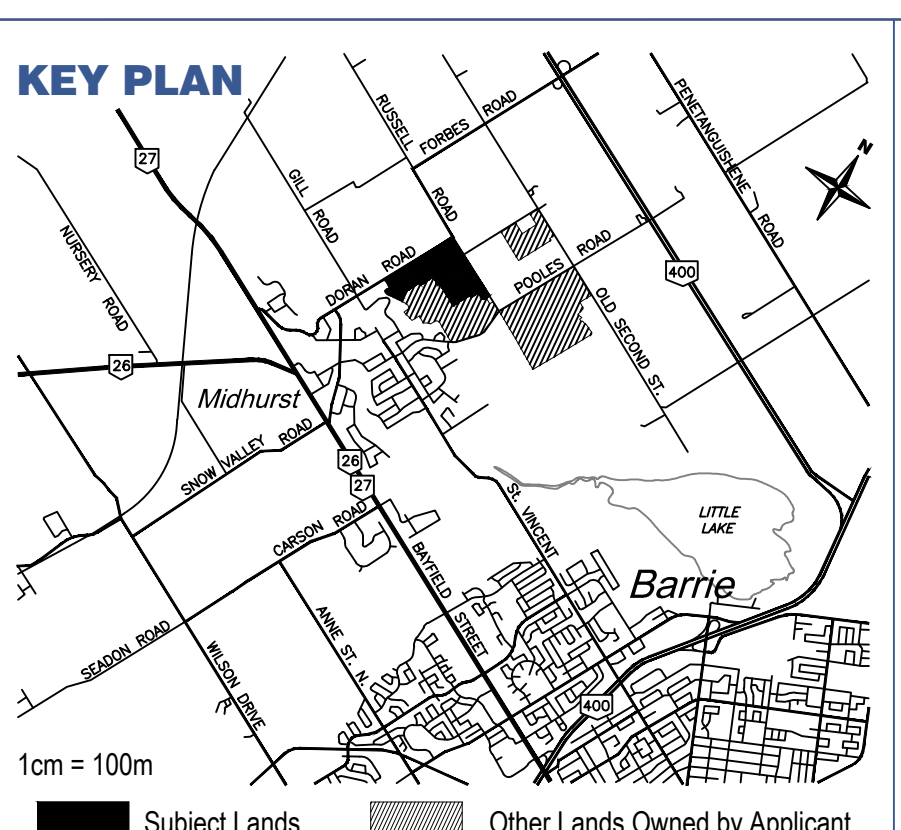

LOT/BLOCK	LAND USE	UNITS	AREA (ha)
Lots 1-569	Single Detached - 12.2m min. (B units)	185	20.58
	Single Detached - 11.0m min. (C units)	109	
	Single Detached - 9.75m min. (D units)	176	
	Single Detached - 11.6m min. Rear Access (E units)	99	
Blocks 570-614	Townhouse Residential RATH 4.50m	341	5.71
Block 615	Mixed Use	0.96	
Block 616	Public Elementary School	2.45	
Blocks 617-620	Parks	3.60	
Block 621	Parkette	0.37	
Blocks 622-623	Open Space	0.29	
Block 624	Environmental Protection Area	0.07	
Block 625	Environmental Protection 10 Buffer	0.16	
Blocks 626-627	Walkways	0.06	
Block 628	Servicing Block	0.07	
Blocks 629-630	Road Widening	1.56	
Blocks 631-637	10.0m Lane-way Blocks	1.44	
Block 638	Future Road	0.06	
Roads	23.0m ROW	1.407m	13.08
	20.0m ROW	4.963m	
TOTAL	Totals	6,370m	50.46

OWNER'S AUTHORIZATION

I hereby authorize Malone Given Parsons Ltd. to prepare and submit this Draft Plan of Subdivision to the County of Simcoe.

SEE ORIGINAL SUBMISSION
1754866 Ontario Inc. _____ Date _____

SEE ORIGINAL SUBMISSION
1754865 Ontario Inc. _____ Date _____

SEE ORIGINAL SUBMISSION
1755571 Ontario Inc. _____ Date _____

ADDITIONAL INFORMATION

AS REQUIRED UNDER SECTION 51(17) OF THE PLANNING ACT, CHAPTER P.13(R.S.O. 1990).

(a),(e),(f),(g),(j),(l) - As shown of the Draft Plan.
(b),(c) - As shown on the Draft and Key Plan.
(d) - Land to be used in accordance with the Schedule of Land Use.
(i) - Sandy loam.
(h),(k) - Full services & Water Supply to be provided.

Prepared by:
MALONE GIVEN PARSONS LTD.
140 Renfrew Drive, Suite 201
Markham, Ontario, L3R 6B3
Tel: (905) 513-0170
www.mgp.ca

MATTHEW J. COYNE
REGISTERED PROFESSIONAL PLANNER
R.P.P.

SURVEYOR'S CERTIFICATE

I hereby certify that the boundaries of the lands to be subdivided as shown on this Plan and their relationship to the adjacent lands are accurately and correctly shown.

SEE ORIGINAL SUBMISSION
Paul Edward
Ontario Land Surveyor
RPE Surveying Ltd. _____ Date _____

Scale: 1:2000

Date: Dec 23, 2009
Project No.: 12-2139

Date	Revision	#
April 26/13	Revised Plan Limits	1
April 8/14	Revisions as per Township & Agency Comments	2
April 17/14	Add Public Elementary School Block	3
April 22/14	Revise Park and Public Elementary School Block	4
May 14/14	Revisions as per Township & Agency Comments	5
May 27/14	Revisions as per Township - Lanes to Blocks	6
June 16/14	Revised to address Township & County Comments	7